

VT SYSTEM

COLLECTIVE FALL PROTECTION
AND ACCESS SOLUTIONS 2023



**WE
SAVE
LIVES**

SAFETYRESPECT®

CONTENTS

Company presentation	2
Product development	3
Factories	4
Logistics	5

EDGE PROTECTION

VT system	6
Barriers	7
Posts	8
Brackets	8

ACCESS SOLUTIONS

Stairways	14
Container podest	16
Trench bridges	18
Lift shaft gate	22
Platform console	24

CONTACT

Head office	28
Depots	28



WE SAVE LIVES

With SafetyRespect, you get more than fall protection products – you get an expert partner who stands by your side. We help you take control of the fall protection in every step of the construction process.

Accidents involving falls are one of the most common causes of injuries and deaths in the construction industry. For that reason, our most important task as fall protection experts is to protect lives. With the right knowledge and smart products, we are convinced that it is possible to bring about positive change.

We provide both fall protection and fall protection training courses for construction projects of all kinds. We are involved throughout the process and carry out calculations, produce documentation, deliver fall protection and carry out safety checks. Focusing at all times on providing you with the best solution for your project.

Since the products are manufactured in our own factories and we ourselves take care of the entire process from sale to logistics, we are close to our customers at all times. We work to develop both our products and our ways of working in line with your needs. Our aim is that you will notice this in your contact with us, every time and in every step.

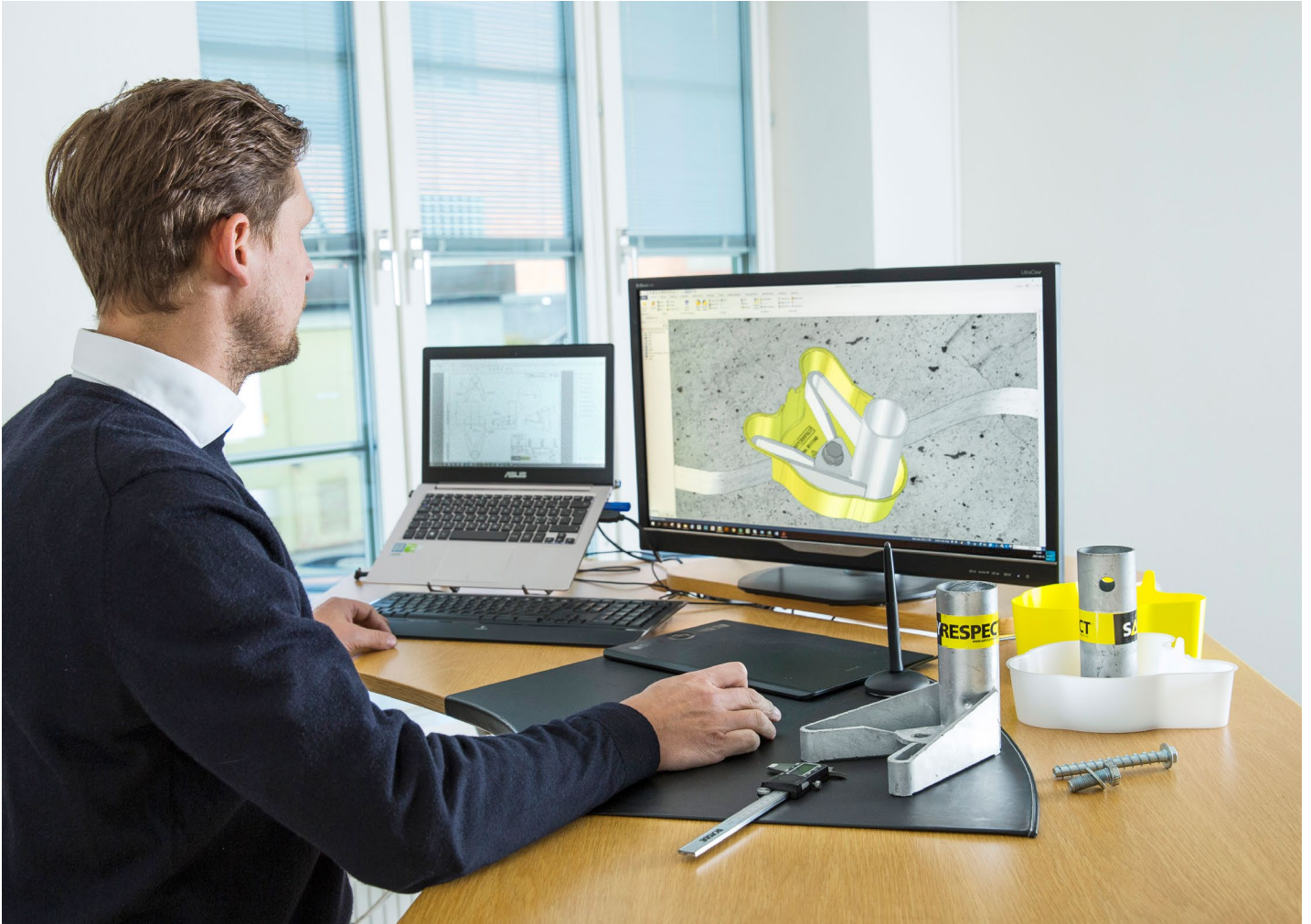

Product development based on the customer

We are close to our customers. That means that your ideas and requirements quickly can be turned into prototypes that can be tested and evaluated both in our own lab and out on actual projects.

We usually work with short development times from the idea to the finished product. Our product council involves people from different positions within our organisation. We are thus able to ensure that the solutions we develop are relevant to the market and that all interested parties are able to have their say.

After a feasibility study, a number of prototypes are developed for testing and evaluation before a final design is produced and preparations for production take place. We often allow a zero batch series to be used on a pilot project to get real feedback from the users before a product is officially launched.





Manufacturing in our own high-tech factories

Our fall protection products are primarily manufactured in our own modern factories. This results in short lead times and excellent potential for customisation.

In SafetyRespect, we control our entire value chain and production forms a key part of that. Our own production gives us greater flexibility, full quality control and also the ability to control capacity according to our needs. For our customers, this mainly provides them with an assurance that that we are able to deliver the right products at the right time.

Our modern machines and equipment and high level of automation enable us to work from a long-term perspective according to clear quality and

environmental goals. The business is of course certified according to the ISO 9001, 14001, 45001 standards, and also EN 1090-1, 2009+A1:2011.

From our factory, we can deliver anywhere in Europe by truck within one week. For longer transports, we have extensive experience of dealing with a range of container solutions.



We solve the logistics

Logistics can be complex in a construction project. Let us arrange the transports for you so the right fall protection is delivered to the right place at the right time.

Our depots puts us in close proximity to our customers. We arrange transports of fall protection from the depots so you get exactly the fall protection you need when

it's time to assemble it. You don't need to have fall protection standing in the workplace for assembly later on. Instead, you have it delivered Just in Time.



VT SYSTEM

The VT system consists of three basic components, a steel barrier, a bottom attachment corresponding to the construction situation and square posts. When mounted they form a temporary edge protection that complies with the safety requirements according to EN 13374.

The VT steel barriers replace the classic 3-part edge protection made of wood, because they are handrail, kneeboard and toeboard in one. The robust steel barriers are versatile, quick-to-install system parts with excellent product quality thanks to the latest production methods. In combination with the VT Post 1500 or various aluminium posts, they are part of a height-adjustable edge protection system. A wide range of attachments is available for a variety of applications. A large selection of RAL colours and, for even greater corrosion protection, an additional pre-galvanisation complete the range.

Depending on the area of application of the temporary edge protection, different bottom attachments are required to mount the post. SafetyRespect offers attachments for all essential areas that comply with the requirements for temporary edge protection in accordance with EN 13374.

The posts were developed for use with the steel barriers. Depending on the construction situation, the post is available in different versions and also a height adjustable version.

**VT STEEL BARRIER
1300x1150 90°R**

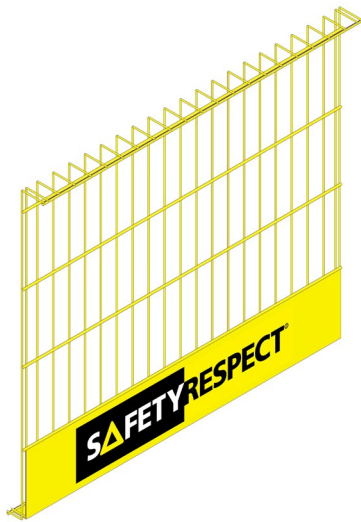

Art. 201131190R

 8.6 kg

 EN 13374 – ABC

 powder-coated

 1300 x 1150 mm

**VT STEEL BARRIER
2600x1150 90° R**

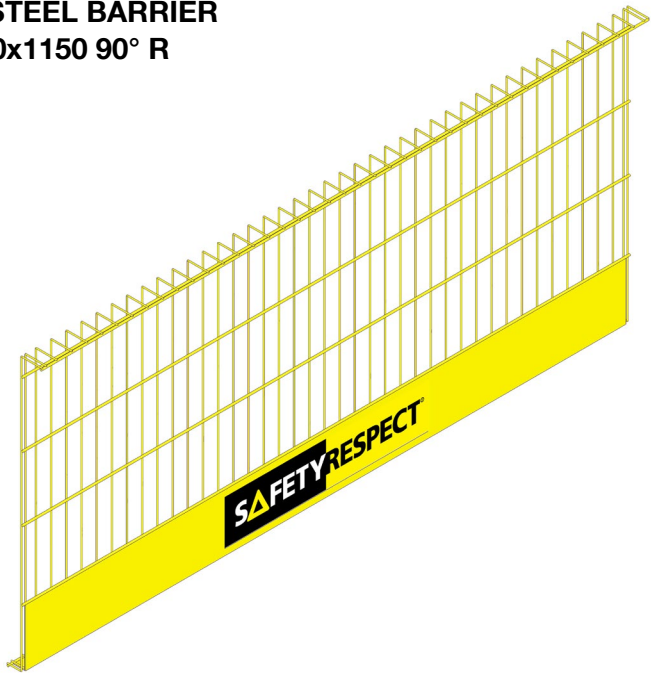

Art. 201261190R

 17.2 kg

 EN 13374 – ABC

 powder-coated

 2600 x 1150 mm

VT BARRIER FRAME 1,3



Art. VT2021312

 8.2 kg

 EN 13374, class A

 powder-coated

 1300 x 1150 mm

VT BARRIER FRAME 2,6

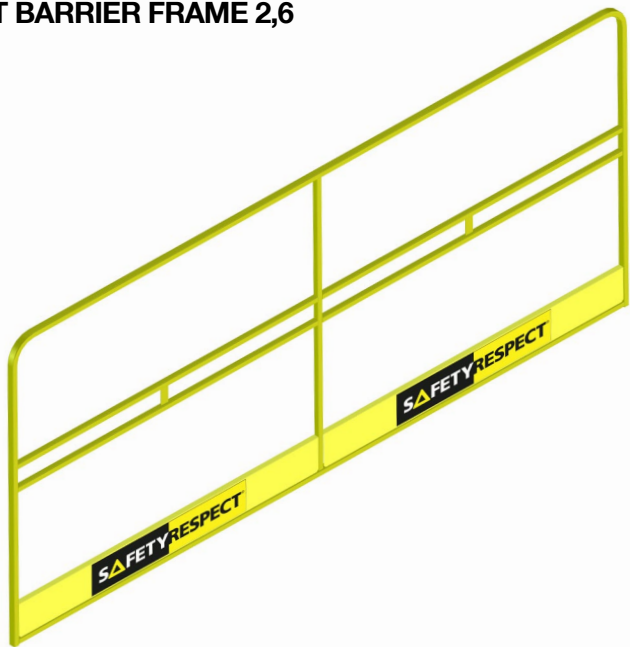

Art. VT2022612

 15.3 kg

 EN 13374, class A

 powder-coated

 2580 x 1150 mm



VT POST 1500 BASIC / INCL. SLIDER

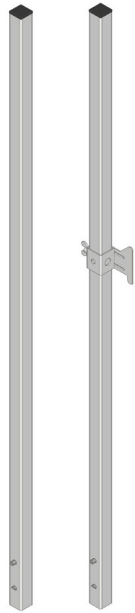

The VT Post 1500 incl. Slider has been developed for use with the VT Steel Barriers. The VT Slider, which is included in the scope of delivery and is equipped with a locking screw, allows the steel barriers to be adjusted to the desired height. Due to the built-in Easy Snap locking mechanism, the VT Post 1500 incl. Slider snaps self-locking into the post holder.

Art. 5031500B / 5031500

 3.3 kg / 3.5 kg

 EN 13374 – ABC

 hot-dip galvanised (HDG)

 1500 x 35 x 35 mm

VT SCAN POST 1200





The VT Scan Post 1200 has been developed for use with the VT Steel Barriers or suitable wooden boards or square timbers. In combination with the VT Toeboard holder (50311951), the result is a multi-part wooden edge protection consisting of handrail, kneeboard and toeboard. The welded-on hooks have holes for nailing or screwing the wooden boards.

Art. 5039003

 3.6 kg

 EN 13374, class A

 hot-dip galvanised (HDG)

 1200 x 35 x 35 mm

VT SLIDER / VT BARRIER HOLDER

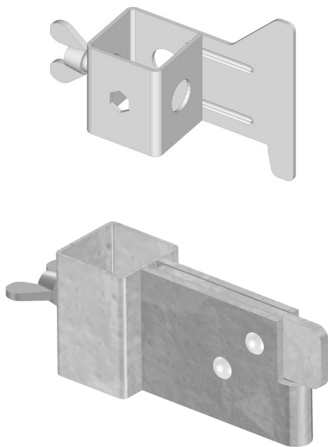

Used for stepless height adjustment of the different steel barriers. The locking screw allows the respective steel barriers to be fixed at the respective height.

Art. 50315008 / 919022

 0.2 kg / 0.6 kg

 EN 13374 – ABC / EN 13374, class A

 Electrogalvanised / hot-dip galvanised

 130 x 92 mm / 172 x 60 x 40 mm

VT POST EXTENSION 240 / 425

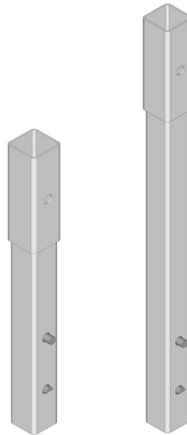

The VT Post Extensions are used to increase the length of posts when the structural conditions require it. The lower part, equipped with the Easy Snap locking mechanism, snaps into the post holder of the attachment and offers the possibility of post fixing with the post holder welded on above.

Art. 5030240 / 5030425

 0.9 kg / 1.3 kg

 EN 13374, class A

 hot-dip galvanised (HDG)

 350 / 535 x 40 x 40 mm

VT TOEBOARD HOLDER

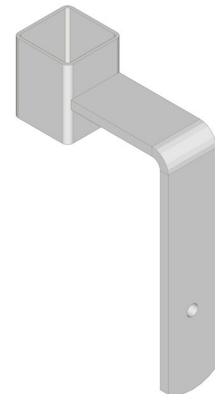

The VT Toeboard Holder is used to attach a toeboard within a 3-part wooden edge protection system. Designed for boards with a height of 150 mm and a thickness of 30 mm, the VT Toeboard Holder is simply pulled onto the post from below.

Art. 50311951

 0.5 kg

 EN 13374, class A

 hot-dip galvanised (HDG)

 178 x 111 mm

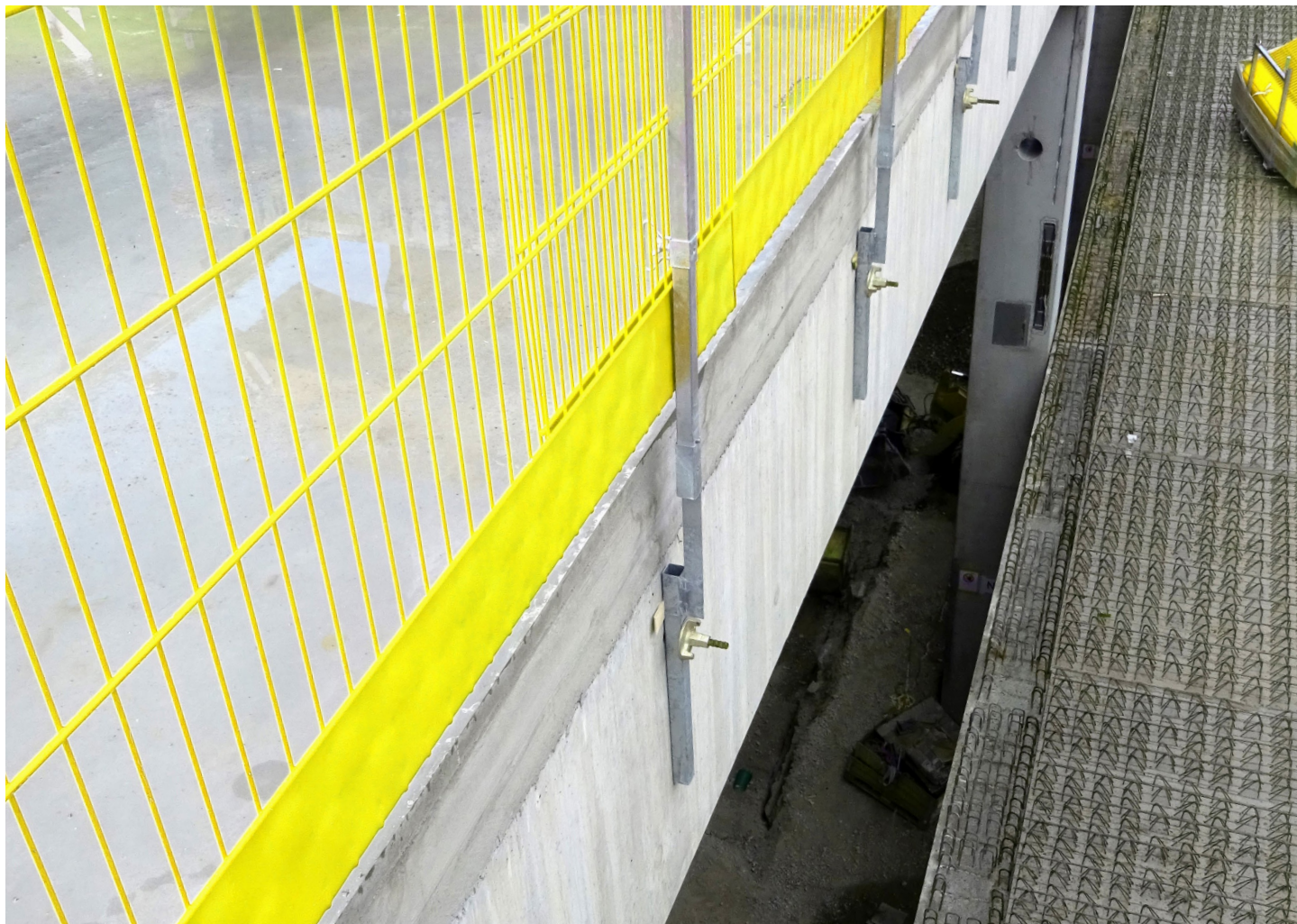

VT FOOT

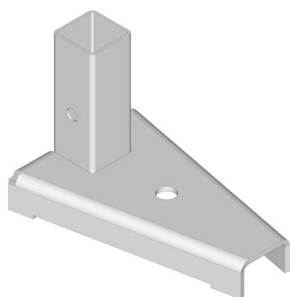

The VT Foot is used to hold an edge protection post on all flat surfaces, e.g. in-situ concrete ceilings. This horizontal attachment can be fastened with various screws and anchors.

Art. 5040001

KG 1.1 kg

§ EN 13374, class A

■ hot-dip galvanised (HDG)

↗ 195 x 130 mm

VT EDGE 100

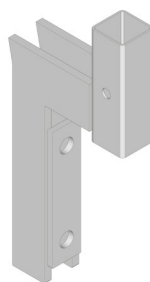

The VT Edge 100 is mainly used to reliably secure the edges of stairs. The cantilever of the post to be used is 100 mm and therefore enables work to be carried out safely on the stairs.

Art. 5040005

KG 1.7 kg

§ EN 13374, class A

■ hot-dip galvanised (HDG)

↗ 300 x 140 mm

VT BALCONY

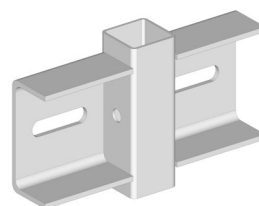

The VT Balcony can be mounted directly on the brickwork or on the balcony and is used to hold an edge protection post. The two attachment points prevent the post holder from swinging out in any situation.

Art. 5040023

KG 1.4 kg

§ EN 13374, class A

■ hot-dip galvanised (HDG)

↗ 200 x 120 mm



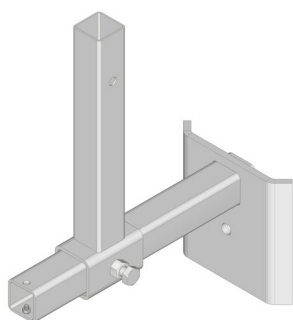

VT STEELWEB 425



The VT Steelweb 425 is designed to connect through a steel beam or onto a vertical surface. The post is adjustable in off set up to 400 mm.

Art. 5040041

 3.9 kg

 EN 13374 – ABC

 hot-dip galvanised (HDG)

 418 x 425 x 155 mm

VT STEELFLANGE

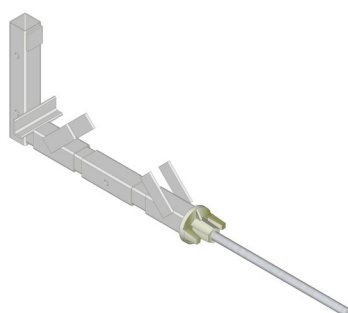

The VT Steelflange is used to hold an edge protection post on steel beams without having to drill for it. This clamp allows clamping widths of 80-460 mm.

Art. 5040007

 3.8 kg

 EN 13374, class A

 hot-dip galvanised (HDG)

 730 x 240 cm

WELD-ON ATTACHMENT, SQUARE



The Weld-on Attachment is welded directly onto the steel beam or steel structure and is used to hold an edge protection post.

Art. 5100021

 0.3 kg

 EN 13374, class A

 blank

 120 mm



VT CLAMP XL 60

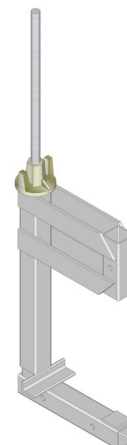

Clamping widths of 50-600 mm and easy to adjust by hand and with a hammer. The clamp has three options for holding posts.

Art. 5040021

KG 5.8 kg

§ EN 13374, class A

■ hot-dip galvanised (HDG)

↗ 730 x 240 mm

VT CLAMP HOOK FOR STAIRCASE

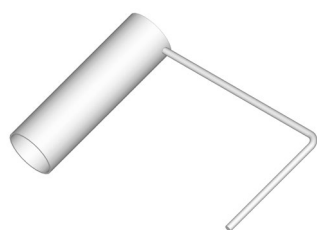

The VT Clamp Hook for Staircase enables safe attachment of the VT Clamp XL 60 to the stair stringer. The lower part of the base body of the clamp is inserted into the clamp holder.

Art. 5041510

KG 1.4 kg

§ -

■ hot-dip galvanised (HDG)

↗ 200 x 300 cm

GROUND SUPPORT PLATE



Support plate for posts and barriers that can be placed on the ground, floor etc. and easily moved if needed. A Socket base is mounted on top as a post holder. Three M16 mounting points.

Art. 912320

KG 7.9 kg

§ EN 13374, class A

■ Zincd and powder coated

↗ 900 x 300 mm

VT HINGE

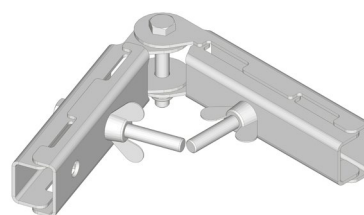

The VT Hinge connects two steel barriers together. Thanks to the hinge, it can be done without one of two posts and one of two post holders for a corner clad with edge protection.

Art. 1100023

KG 0.6 kg

§ -

■ electrogalvanised

↗ 316 mm

VT SHEET PILE CLAMP

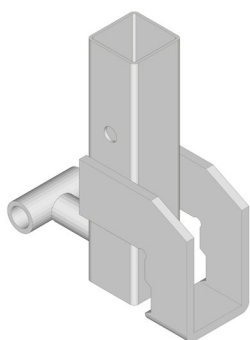

The VT Sheet Pile Clamp is placed on sheet pile profiles or trench sheets from 5-15 mm and fastened. It is easy to install thanks to the integrated DW15 nut and the locking thread.

Art. 1100002

KG 1.4 kg

§ EN 13374, class A

■ electrogalvanised

↗ 175 x 112 mm



VT CLAMP 150

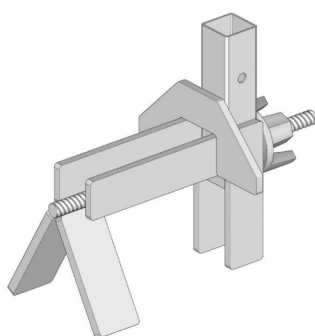

This clamp is used to attach standard edge protection to sheet pile profiles, trench shoring panels and HEB beams. Clamping width up to 150 mm and easy to mount. Tightening using a hammer.

Art. 5040034

KG 4.8 kg

§ EN 13374, class A

■ galvanized

↗ 330 x 249 x 180 mm

EURO BOX

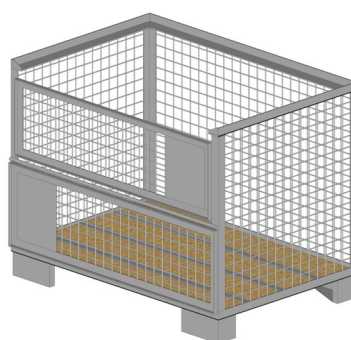

The Euro Box is a standardized means of transportation for the safe transport of goods.

Art. 6010003

KG 70 kg

§ EN 13626

■ painted

↗ 1240 x 840 x 970 mm

BARRIER FRAME 60

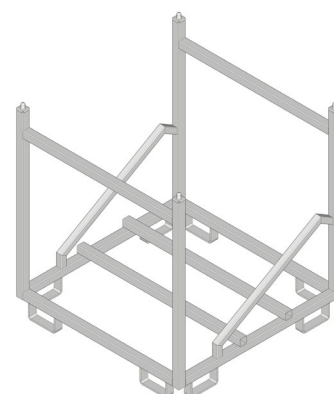

Depending on the type of barrier, between 45 and 60 barriers can be transported.

Art. 2010007

KG 89 kg

§ EN 13374, class A

■ hot-dip galvanised (HDG)

↗ 1335 x 1200 x 1200 mm



STAIRWAYS

Our Stairways can be supplied in two widths, 70 cm and 100 cm.

- The Stairway 70 has a total width of approx. 800 mm, the inner width is approx. 700 mm.
- The Stairway 100 has a total width of approx. 1,100 mm, the inner width is approx. 1,000 mm.
- The SafetyRespect Stairways are available in 6 different lengths, which can be safely connected to each other. In this way, height differences of up to 4.75 m can be conquered with a single Stairway.
- The maximum number of steps is 21. For this, two Stairways must be connected to each other (e.g. an 18-step Stairway with a 3-step Stairway). All necessary fasteners are included in the scope of delivery.
- Each Stairway is supplied with two handrails that adjust to the inclination angle of the Stairway.
- The foldable steps always remain horizontal, the inclination angle of the Stairway has no influence on this.

- The Stairway gets its stability as soon as it is at the right angle.
- The Stairways are made of galvanised square steel tubes. The steps are made of non-slip, punched sheet metal. The four stair feet guarantee a high degree of stability.
- To simplify transport and storage, the Stairways can be folded flat.
- The Stairways can be pre-assembled to the required length before transport. However, on-site assembly is possible without any effort.
- Two people can easily erect the Stairways on site. The handrails have to be inserted, the special lifting devices help to bring the Stairways into the desired position.

All VT Stairways are manufactured in accordance with the European standard EN 12811. This standard defines the performance requirements and general design of temporary structures for buildings.

STAIRWAY 700, 3 STEPS**Art.** 5060003

39 kg

EN 12811

hot-dip galvanised (HDG)

 dimensions: 1640 x 800 mm
height: 510 - 835 mm**STAIRWAY 700, 6 STEPS****Art.** 5060006

62 kg

EN 12811

hot-dip galvanised (HDG)

 dimensions: 2450 x 800 mm
height: 920 - 1505 mm**STAIRWAY 700, 9 STEPS****Art.** 5060009

83 kg

EN 12811

hot-dip galvanised (HDG)

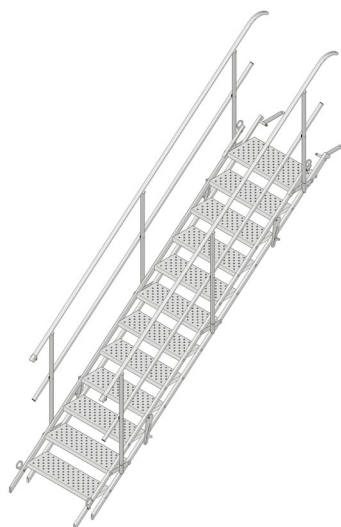
 dimensions: 3260 x 800 mm
height: 1320 - 2160 mm**STAIRWAY 700, 12 STEPS****Art.** 5060012

110 kg

EN 12811

hot-dip galvanised (HDG)

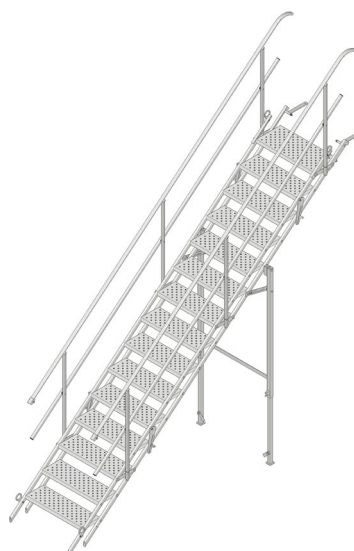
 dimensions: 4070 x 800 mm
height: 1725 - 2825 mm**STAIRWAY 700, 15 STEPS****Art.** 5060015

147 kg

EN 12811

hot-dip galvanised (HDG)

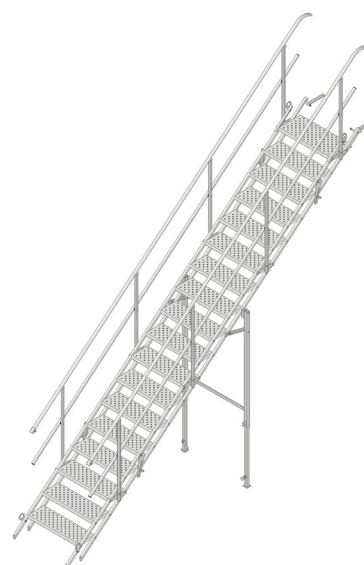
 dimensions: 4610 x 800 mm
height: 2130 - 3490 mm**STAIRWAY 700, 18 STEPS****Art.** 5060018

174 kg

EN 12811

hot-dip galvanised (HDG)

 dimensions: 5420 x 800 mm
height: 2535 - 4155 mm

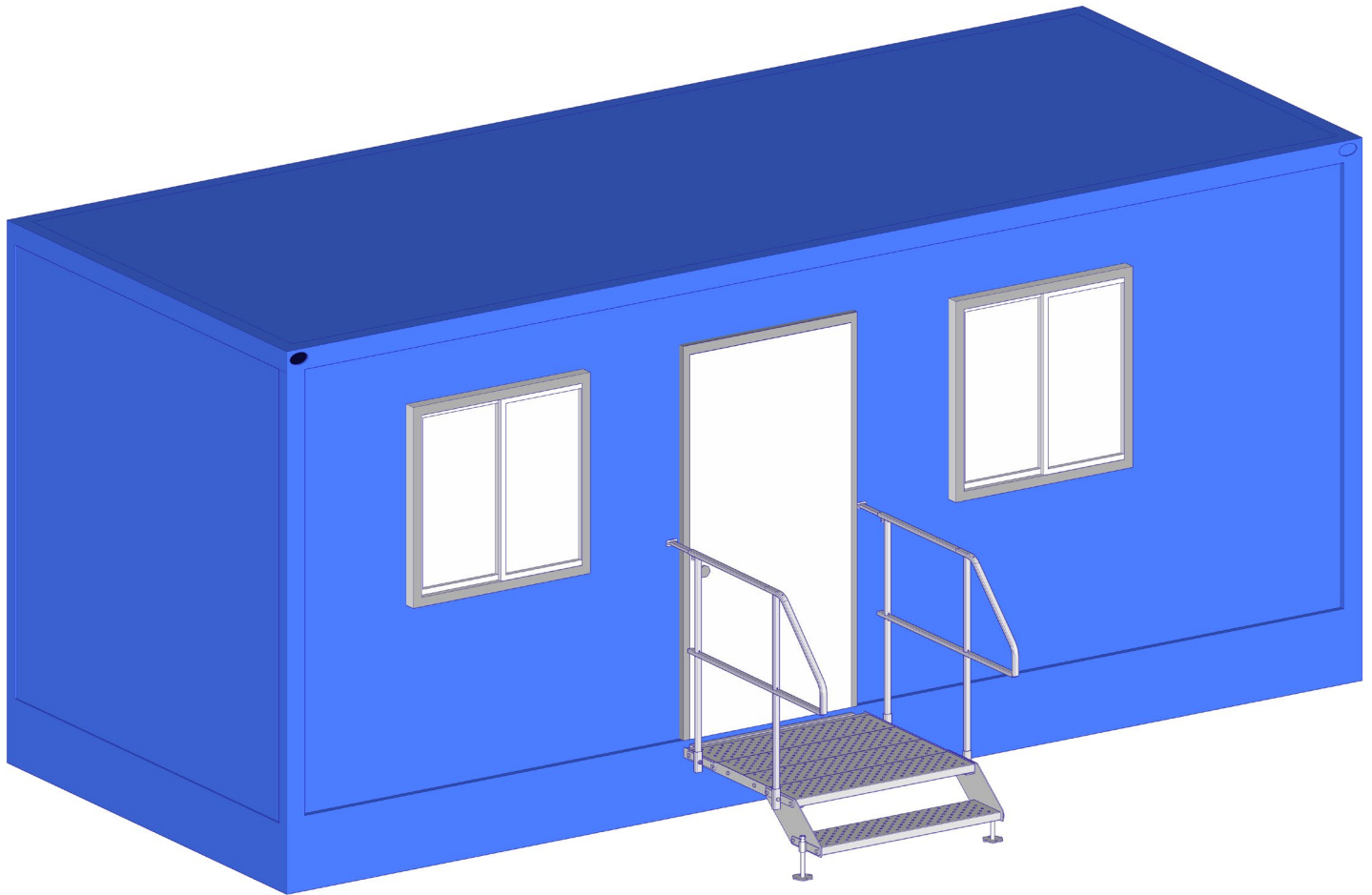

CONTAINER PODEST

The Container Podest is a simple and consistently modular solution for access to construction and office containers. The podest surface is 1x1 m.

Unlike other entrance staircases, the Container Podest consists of a single-step basic module, which can then be extended in advance or on site with one or two Podest Extension Sets, depending on the requirements, floor conditions, etc. In this way, a two- or three-level podest can easily be formed from a single-level podest.

With the help of a few accessories, the forward-facing podest can also be converted into a 90° Container Podest, which is helpful in confined spaces or with narrow access routes.

The two handrails are part of the delivery, whereby the extension in the handrail can be telescoped outwards and then fixed to enable a handrail connection to the container.

The Container Podest is fixed by the bolted U-profile, which is hooked into the Container Attachments previously screwed to the container.

To compensate for uneven floors, the support feet can be adjusted in height by almost 200 mm thanks to the welded-on thread. This ensures that the Container Podest is always levelled.



PODEST 1000**Art.** 2400001

61 kg

EN 12811

hot-dip galvanised (HDG)

1351 x 1291 x 1164 mm

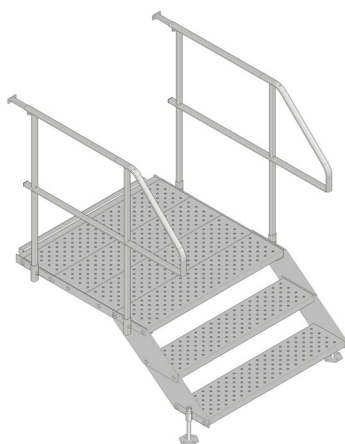
PODEST 1000-2**Art.** 2400002

72 kg

EN 12811

hot-dip galvanised (HDG)

1526 x 1403 x 1164 mm

PODEST 1000-3**Art.** 2400003

83 kg

EN 12811

hot-dip galvanised (HDG)

1701 x 1632 x 1164 mm

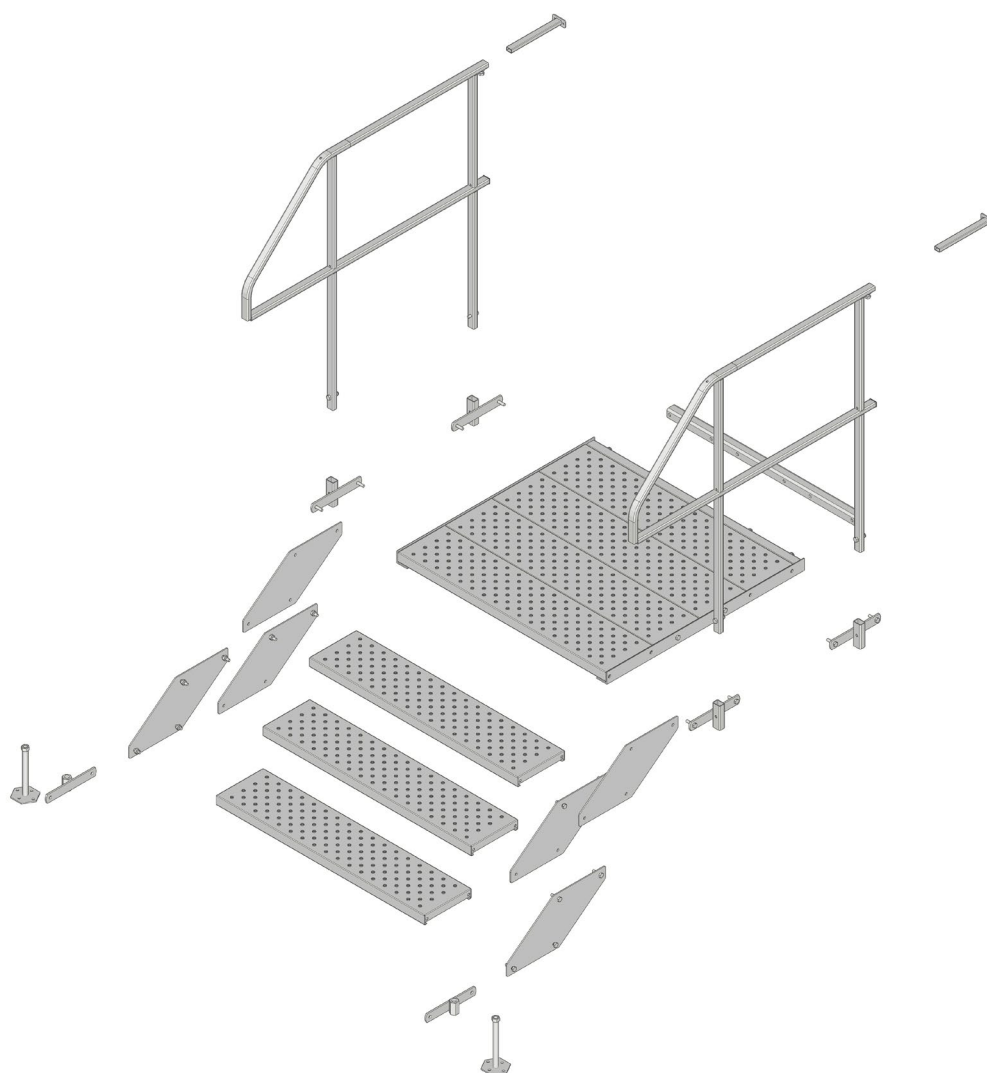



TRENCH BRIDGES

The Trench Bridges ensure a safe crossing over open channel trenches. They are made of steel with non-slip treads. This allows unrestricted business operations during construction work. All trench bridges are flexibly implementable and convertible.

Each Trench Bridge carries 5 kN/m². The Trench Bridges are available in 5 lengths as standard, from 2 m total length up to 8 m. Pre-assembled crane hooks allow safe craning and positioning above the trench or excavation. Following the consistent modular principle, all individual parts of the Trench Bridges are replaceable in case of damage. All Trench Bridges are available with handrails.

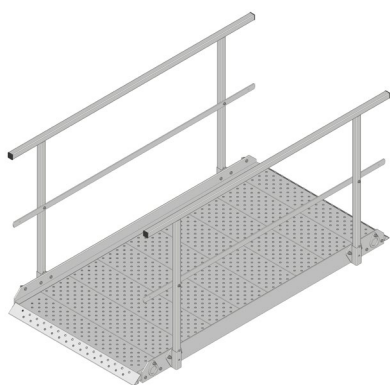

- Stackable for transport and storage.
- Separate handrails.
- Non-slip treads.

TRENCH BRIDGE 2 M**Art.** 5062020N

136 kg

EN 12811

hot-dip galvanised (HDG)

2037 x 1137 mm

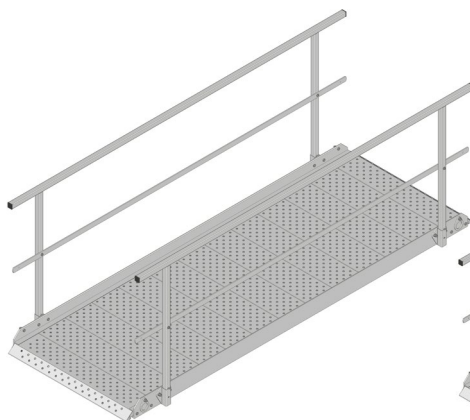
TRENCH BRIDGE 3 M**Art.** 5062030N

190 kg

EN 12811

hot-dip galvanised (HDG)

2935 x 1137 mm

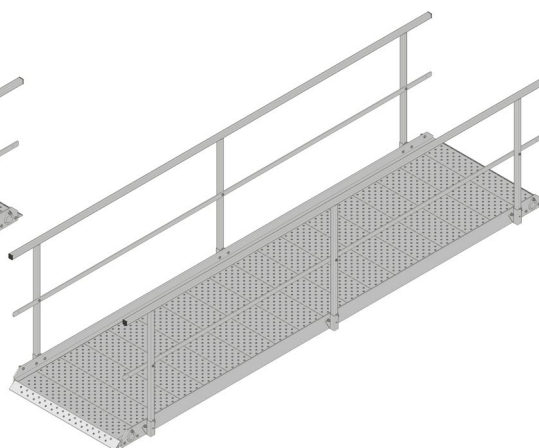
TRENCH BRIDGE 4 M**Art.** 5062040N

263 kg

EN 12811

hot-dip galvanised (HDG)

4063 x 1137 mm

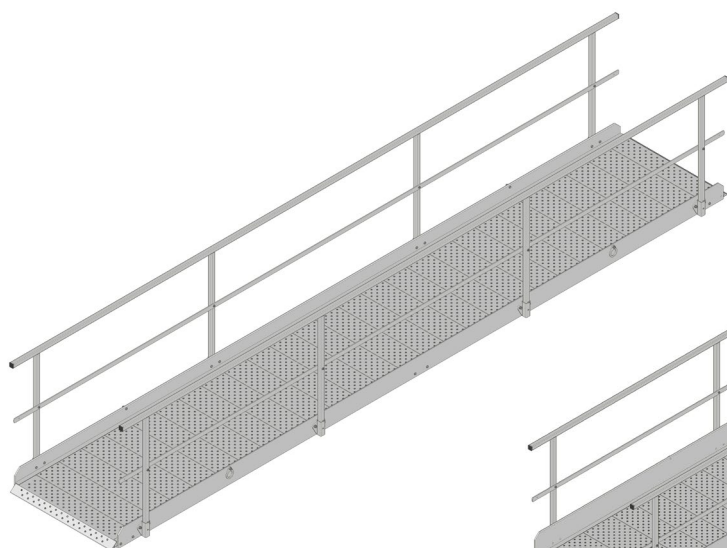
TRENCH BRIDGE 6 M**Art.** 5062060N

465 kg

EN 12811

hot-dip galvanised (HDG)

6090 x 1141 mm

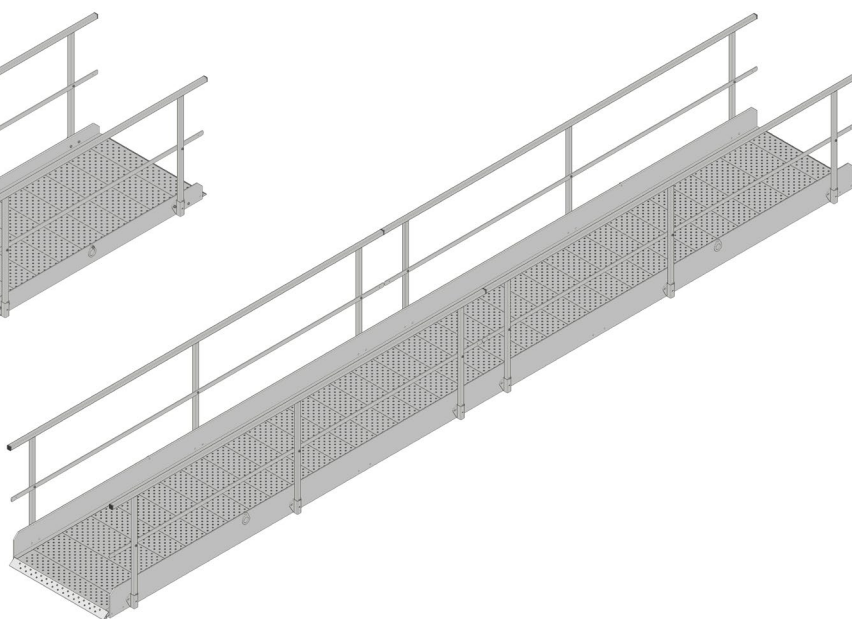
TRENCH BRIDGE 8 M**Art.** 5062080N

743 kg

EN 12811

hot-dip galvanised (HDG)

7990 x 1141 mm

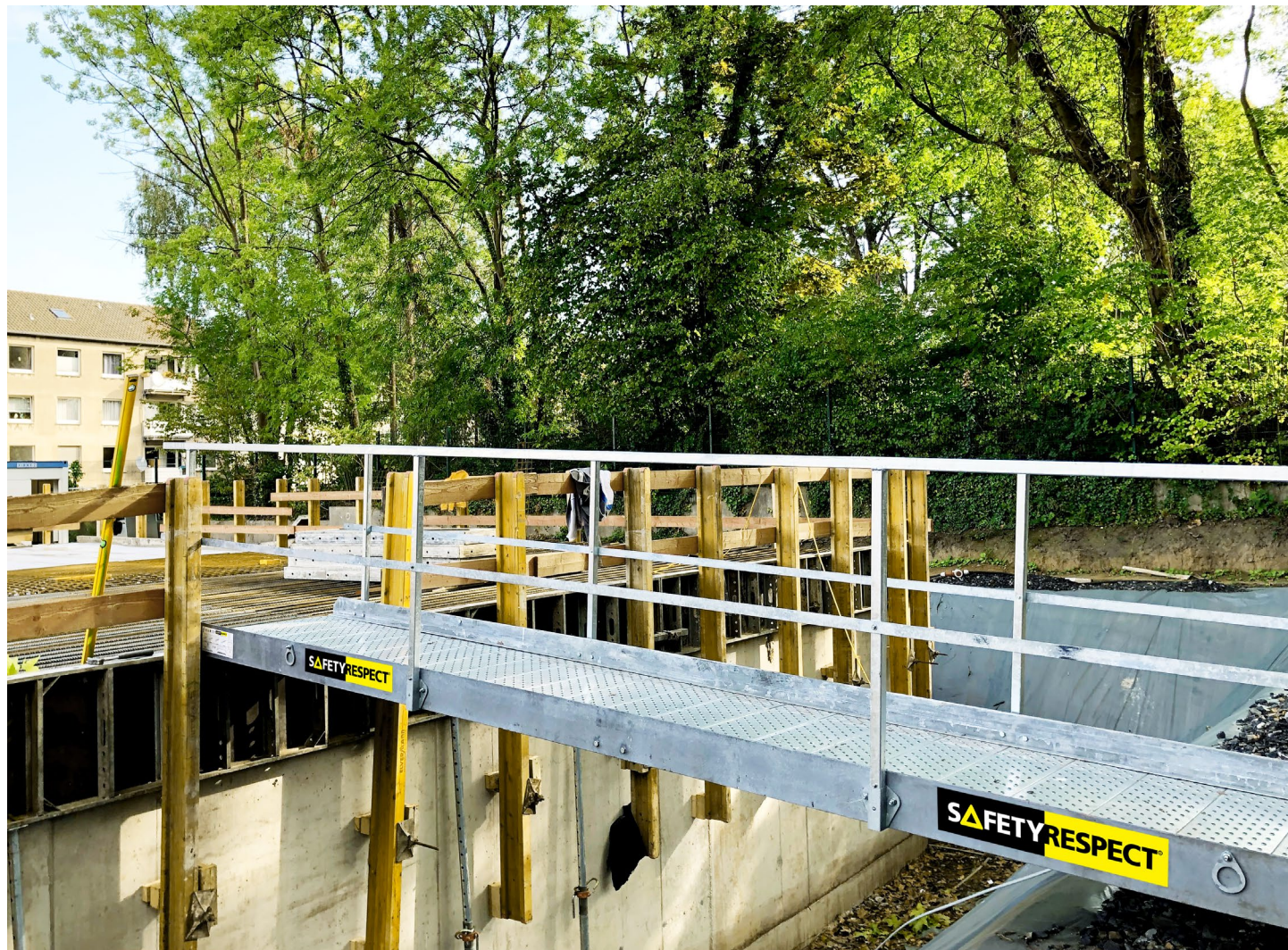

ENTRY STEP 230 X 1000

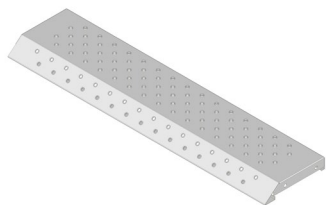

Art. 6200000017

 5.5 kg

 hot-dip galvanised (HDG)

STEP 225 X 1000 STEP 305 X 1000

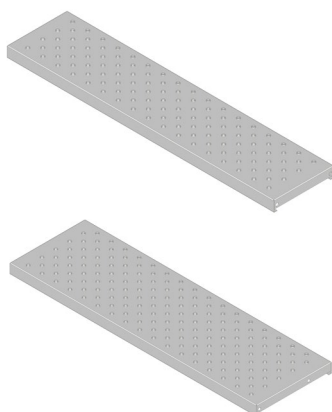

Art. 5161012, 5161013

 5.1 kg, 6.4 kg

 hot-dip galvanised (HDG)

HANDRAIL



Art. 50620201 (2m)
 12 kg

Art. 50620301 (3m)
 15.5 kg

Art. 50620401 (4m)
 22.1 kg

Art. 50620601 (6m)
 32.1 kg

 hot-dip galvanised (HDG)



POST HOLDER FOR TRENCH BRIDGE

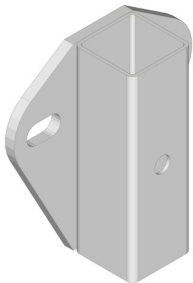

Art. 5062001

KG 1.3 kg

 hot-dip galvanised (HDG)

BRACE 995

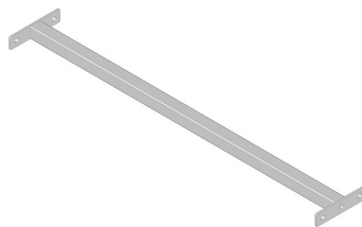

Art. X18000257

KG 2.8 kg

 hot-dip galvanised (HDG)

CRANE HOOK 50



Art. 5161002

KG 0.2 kg

 hot-dip galvanised (HDG)

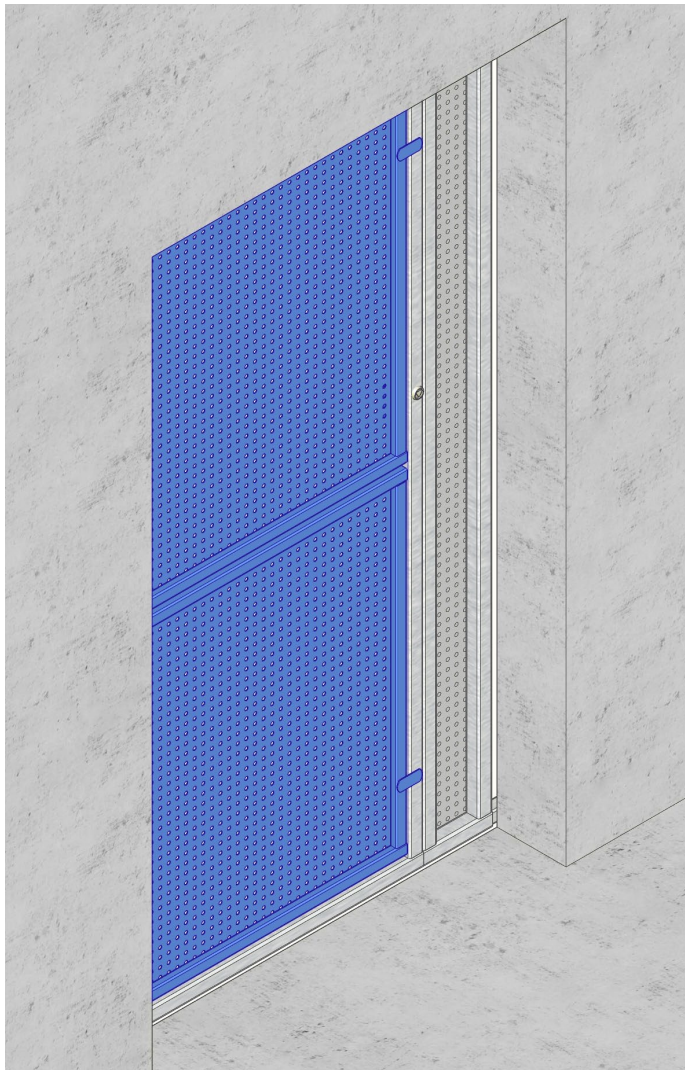
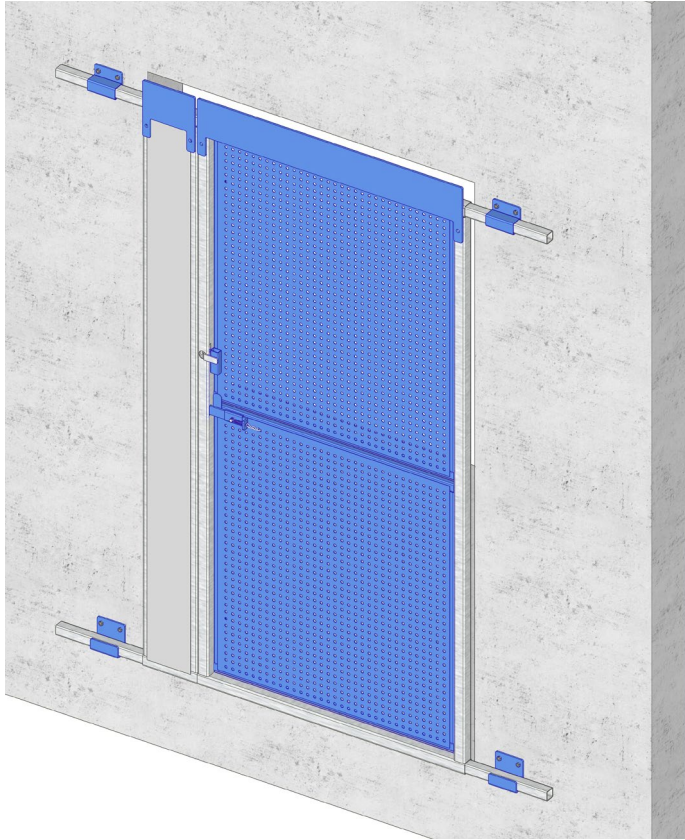

LIFT SHAFT GATE

The Lift Shaft Gate is the safe and versatile alternative to other safeguards for lift shafts in civil engineering.

On the one hand, this temporary shaft door protects the construction site personnel from accidents and functions as a fall protection in this respect. On the other hand, it ensures easy access to carry out work inside the shaft.

The Lift Shaft Gate can be installed from the outside as well as from the inside, with the help of the fixing brackets and suspension tubes. The upper door can be opened separately, e.g. to allow tools to be handed in.

The built-in triangular lock prevents uninvited access to the shaft, yet the intelligent design allows the entire door to be opened from the inside without a key to ensure smooth escape in case of fire or danger.

The door, which weighs less than 40 kg, can easily be adapted to the structural conditions for wider shaft openings. For this purpose, the panels are used to fill the desired width. Panels and door can be set up in various combinations to customize according to specific needs. Gap covers for attachment to the upper end of the Lift Shaft Gate complete the range.

LIFT SHAFT DOOR

The Lift Shaft Door can be opened as a whole or only the upper half of the door. The integrated triangular lock prevents unauthorised entry or accidents.

Art. 5071201

KG 39.3 kg

§ EN 13374, class A

■ hot-dip galvanised / powder-coated

↗ 2060 x 980 mm

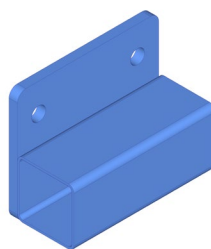
FIXING BRACKET, TOP

The upper Fixing Bracket is anchored to the wall from the outside or inside and holds the upper suspension tube. Two upper fixing brackets are required per Lift Shaft Gate.

Art. 5071209

KG 0.5 kg

§ -

■ powder-coated

↗ 80 x 100 mm

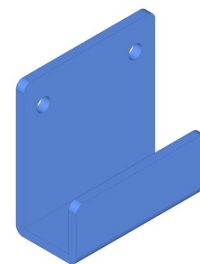
FIXING BRACKET, BOTTOM

The lower Fixing Bracket is anchored to the wall from the outside or inside and holds the upper suspension tube. Two lower fixing brackets are required per Lift Shaft Gate.

Art. 5071210

KG 0.6 kg

§ -

■ powder-coated

↗ 100 x 100 mm

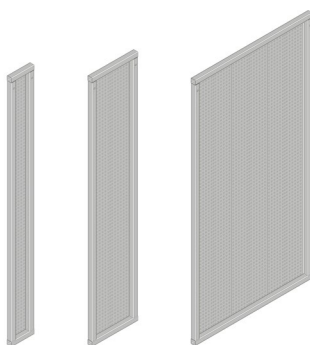
PANEL 200 / 400 / 1050

The Panels are attached to the hanger beams in the same manner as the Door. Different width options that can be combined to customize the set up for the intended shaft opening.

Art. 5071202 / 5071203 / 5071204

KG 15.6 / 23.4 / 34 kg

§ -

■ hot-dip galvanised (HDG)

↗ 2060 x 200 / 400 / 1050 mm

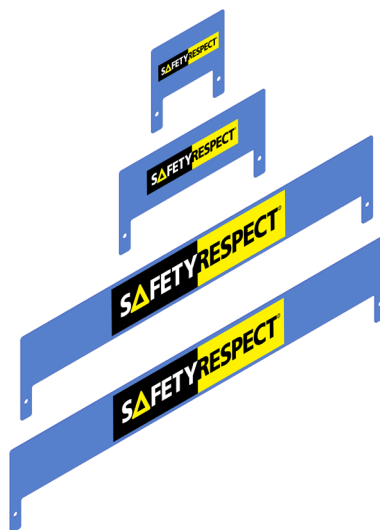
**GAP COVER
200 / 400 / 980 / 1050**

The Gap Covers close any gaps between the lift shaft door and the top edge of the shaft opening.

Art. 5071211, 5071212, 5071213, 5071214

KG 0.5 kg, 0.9 kg, 2.0 kg, 2.2 kg

§ -

■ powder-coated

↗ 200 x 200 / 400 / 980 / 1050 mm

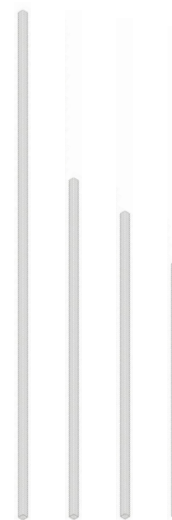
SUSPENSION TUBE

The Suspension Tubes act as the basic framework of the Lift Shaft Gate and are held in place by the fixing brackets.

Art. 5071202 / 5071203 / 5071204

KG 15.6 / 23.4 / 34 kg

§ -

■ hot-dip galvanised (HDG)

↗ 2060 x 200 / 400 / 1050 mm



SR PLATFORM CONSOLE



The SR Platform console accommodates a wooden beam with a width < 55 mm and thus forms a substructure for safe working platforms, e.g. in shafts and openings.

Art. 930089

KG 1.4 kg

S -

hot-dip galvanised (HDG)

214 x 193 x 80 mm

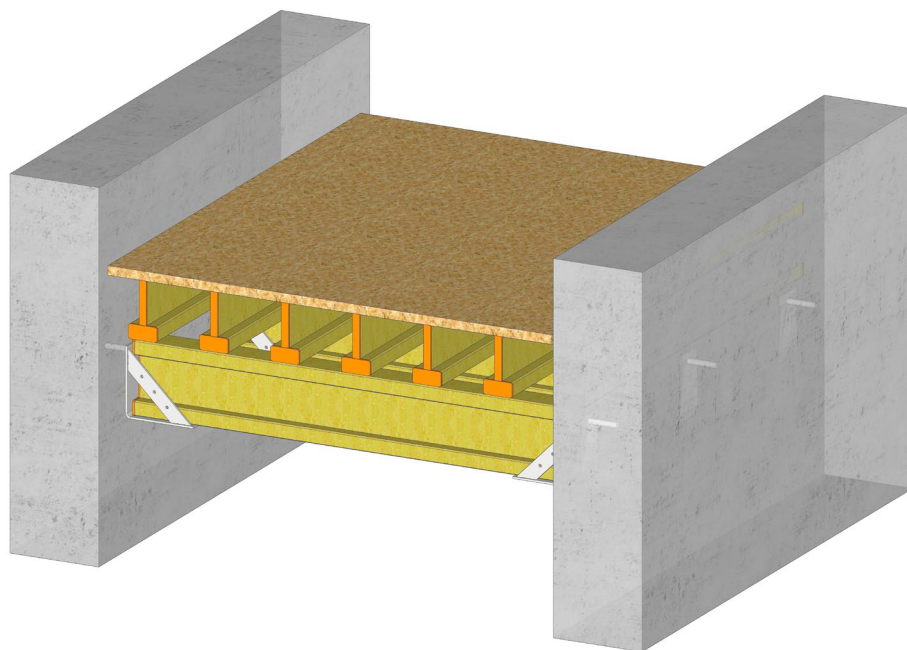







With SafetyRespect, you get more than fall protection products
– you get an expert partner who stands by your side.

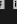
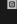

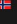
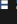
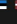

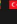
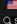

[HOME](#)
[NEWS](#)
[SERVICES](#)
[ACADEMY](#)
[SOLUTIONS](#)
[PRODUCTS](#)
[RESOURCES](#)
[CONTACT](#)

Search



WE SAVE LIVES



A FALL PROTECTION EXPERT WITH A COMPLETE SOLUTION

With SafetyRespect, you get more than fall protection products – you get an expert partner who stands by your side. We help you take control of the fall protection in every step of the construction process.



TRAINING COURSES

Working at height can be dangerous – for that reason it is important to be aware of the risks and to know how to prevent them. Our courses at the SafetyRespect Academy help you create a safer working environment.



PERSONAL FALL PROTECTION

Our range of personal fall protection includes ready-made kits for different situations in the construction project, for example for work on roofs or from a mobile platform. This makes it easy to choose the right protection.



COLLECTIVE FALL PROTECTION

We are constantly developing new products in collective fall protection in order to meet our customers' need for safe construction sites. We have solutions for most situations where there is a risk of falling.

Visit our website www.safetyrespect.com for more information, and to download brochures, product sheets and user manuals.



WE SAVE LIVES

FALL PROTECTION GUIDE 2022





MOUNTING INSTRUCTIONS EDGE PROTECTION SYSTEMS

MONTERINGSANVISNING FALLSKYDDSYSTEM
 MONTASJEANVISNING FALLSIKRINGSSYSTEM
 MONTERINGSANVISNING FALLSIKRINGSSYSTEM
 PUOTAMISUOJAKSEN ASENNUSOHJE
 KRAŠTŲ APSAUGOS SISTEMŲ MONTAVIMO INSTRUKCIJOS
 INSTRUCTIONS DE MONTAGE SYSTÈME DE SÉCURITÉ ANTICHUTE
 INSTRUCCIONES DE MONTAJE SISTEMAS ANTICAÍDAS
 KENAR KORUMA SİSTEMLERİ MONTAJ TALİMATNAMESİ
 ИНСТРУКЦИЯ ПО МОНТАЖУ ЗАЩИТНОЙ СИСТЕМЫ ОТ ПАДЕНИЙ
 نظام الحماية من السقوط





SAFETYRESPECT • info@safetyrespect.com • www.safetyrespect.com









PRODUCT SHEET

PART NO 913151, 913161, 913141



FRAME BARRIER ALU

Räckesram alu | Rekkverkramme alu | Rémínis áttvaras alu | Alumínium perçeve

 L: 1300/1950/2600 mm
 W: 25 mm
 H: 1165 mm
 5,7/8,1/10,3 kg
 Steel + Zn + Powder coating
 EN13374





 1,3-2,6 x 0,91 x 1,42 m
 195/260/320 kg
 27 pcs

913151

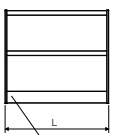

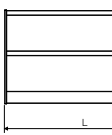

913161



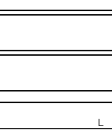

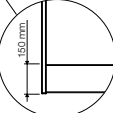
913141

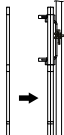

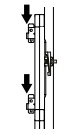

info@safetyrespect.com • www.safetyrespect.com



SWEDEN

HEAD OFFICE

+46 (0)63 13 04 00
info@safetyrespect.se
www.safetyrespect.se

DELIVERIES

Storsjöstråket 15
831 34 Östersund
Sweden

MAIL

Box 69
SE-831 21 Östersund
Sweden

NORTH – PITEÅ

+46 (0)911-21 08 90
norr@safetyrespect.se

SafetyRespect AB
Traversvägen 3
941 43 Piteå
Sweden

EAST – STOCKHOLM

+46 (0)8 584 90 400
sto@safetyrespect.se

SafetyRespect AB
Fagerstagatan 16
163 53 Spånga
Sweden

WEST – GOTHENBURG

+46 (0)31 701 74 00
got@safetyrespect.se

SafetyRespect AB
Lilla Marieholmsgatan 7
415 02 Göteborg
Sweden

SOUTH – STAFFANSTORP

+46 (0)46 12 44 00
syd@safetyrespect.se

SafetyRespect AB
Spånvägen 15A
245 34 Staffanstorp
Sweden

NORWAY

+47 22 32 72 32
info@safetyrespect.no
www.safetyrespect.no

SafetyRespect
Stamveien 8 & 9
1481 Hagan
Norway

FINLAND

+372 5333 5940
meelis.tamm@safetyrespect.com
www.safetyrespect.com

SafetyRespect
Konetie 8
04300 Tuusula
Finland

LITHUANIA

+370 5 233 4400
info@safetyrespect.lt
www.safetyrespect.lt

SafetyRespect UAB
Ukmergės g. 427 C
LT-14185, Bukiškio km
Vilniaus raj
Lithuania

LATVIA

Sales and project manager
Aleksandrs Belovs
aleksandrs.belovs@safetyrespect.com
+371 278 124 11

www.safetyrespect.com

ESTONIA

Business development manager
Meelis Tamm
meelis.tamm@safetyrespect.com
+372 5333 5940

www.safetyrespect.com

GERMANY

+49 (0)2371 15541-0
info@safetyrespect.de
www.safetyrespect.de

SafetyRespect GmbH
Im Kurzen Busch 11
58640 Iserlohn
Germany

UK

+44 (0)7860 111 212
info@safetyrespect.co.uk
www.safetyrespect.co.uk

SafetyRespect UK Limited
2 Hope Street, Leigh
Gt. Manchester, WN7 1AJ
United Kingdom

TÜRKIYE

+90 216 307 8787
infotr@safetyrespect.se
www.safetyrespect.com.tr

SafetyRespect LTD
Kozyatağı mah. Şehit İlknur Keleş
Sok. No:7 Hüseyin Bağdatlıoğlu İş
Merkezi Kat:4 Daire:8
Kadıköy – İstanbul
Türkiye

USA

+1 714 463 4589
infous@safetyrespect.com
https://us.safetyrespect.com

SafetyRespect Inc.
22445 La Palma Ave, Unit C
Yorba Linda, CA 92887
USA